

# TWICKENHAM FILM STUDIOS LIMITED

## Technical Data

The attention of the Licensee is drawn to the undermentioned Technical Data, which should be communicated to their Riggers:

*Re-loading of existing beams affixed to roof over Stage One, Stage Two and Stage Three. These beams should be restricted to maximum 10 Cwts per span, i.e. between supports.*

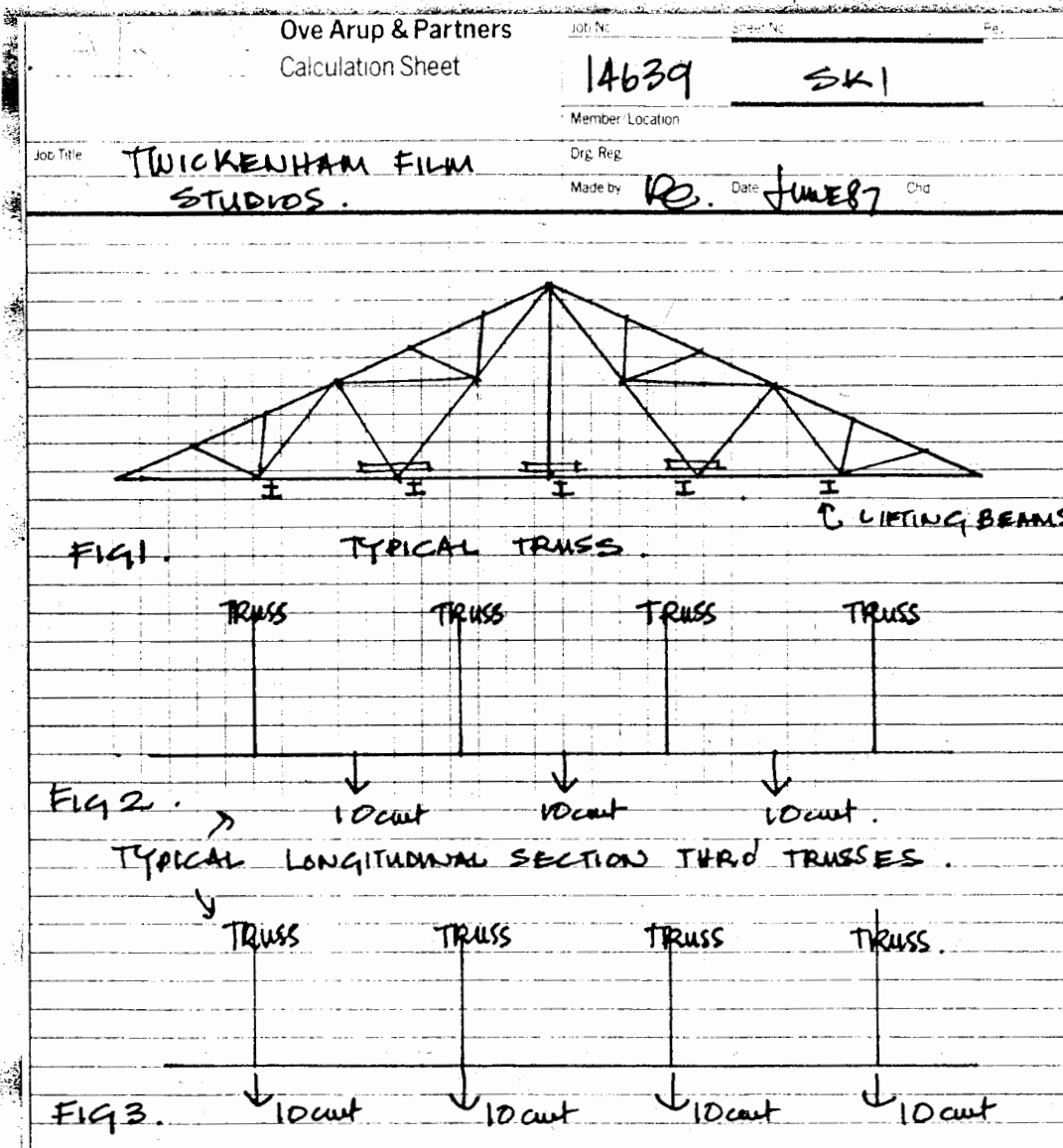

The following conditions are applicable:

- The loads are supported by the lifting beams
- The loads are limited to 10 Cwt or less
- The load is positioned directly under a truss or at a mid-point between trusses, ensuring that no truss carries more than 10 Cwt at each lifting beam point.